

# M25 junction 28 improvement scheme TR010029

## 2.4 Streets, rights of way and access

APFP Regulation 5(2)(k)  
Planning Act 2008

Infrastructure Planning (Applications: Prescribed Forms and Procedure) Regulations 2009



# Infrastructure Planning

## Planning Act 2008

### The Infrastructure Planning (Applications: Prescribed Forms and Procedure) Regulations 2009

#### M25 junction 28 improvement scheme Development Consent Order 202[x ]

---

#### 2.4 STREETS, RIGHTS OF WAY AND ACCESS PLANS

---

<b>Regulation Number:</b>	Regulation 5(2)(k)
<b>Planning Inspectorate Scheme Reference</b>	TR010029
<b>Application Document Reference</b>	TR010029/APP/2.4
<b>Author:</b>	M25 junction 28 scheme, Project Team, Highways England

<b>Version</b>	<b>Date</b>	<b>Status of Version</b>
<u>1</u>	<u>April 2021</u>	<u>Deadline 5, incorporated changes 1-4</u>
0	May 2020	Application issue

# Table of contents

<b>Chapter</b>	<b>Pages</b>
1. <b>Introduction</b>	<b>4</b>
2. <b>Schedule of plans included in this application document</b>	<b>5</b>

# 1. Introduction

- 1.1.1 Highways England (the “Applicant”) has applied to the Secretary of State for a Development Consent Order (“DCO”) to authorise a scheme for alterations to the M25 junction 28 (the “Scheme”). The application is submitted to the Planning Inspectorate (the “Inspectorate”) in accordance with section 37 of the Planning Act 2008 (the “2008 Act”).
- 1.1.2 This document comprises part of the suite of application documents and is submitted in compliance with Regulation 5(2)(k) and Regulation 5(4) of the Infrastructure Planning (Applications: Prescribed Forms and Procedure) Regulations 2009, which require:
- 5(2)(k)- ‘where applicable, a plan identifying any new or altered means of access, stopping up of streets or roads or any diversions, extinguishments or creation of rights of way or public rights of navigation’.*
- 5(4) – ‘Where a plan comprises three or more separate sheets a key plan must be provided showing the relationship between the different sheets’.*
- 1.1.3 This document is to be read in conjunction with other application documents, in particular, Schedule 1 (Authorised Development), Schedule 4 (Permanent Stopping Up of Highways and Private Means of Access and Provision of New Highways and Private Means of Access) and Schedule 5 (Classification of Roads, etc.) to the draft DCO (application document TR010029/APP/3.1 [\(4\)](#)).

## **2. Schedule of plans included in this application document**

### **1.1.42.1.1 Streets, rights of way and access plans (Key Plan, Sheet 1 and 3 of 4) have been updated at Deadline 5.**

<b>Document title</b>	<b>Document number</b>	<b>Version</b>
2.4 Streets, rights of way and access plans - Regulation 5(2)(k) Key Plan	TR010029/APP/2.4	<del>0</del> <u>1</u>
2.4 Streets, rights of way and access plans - Regulation 5(2)(k) Sheet 1 of 4	TR010029/APP/2.4	<del>0</del> <u>1</u>
2.4 Streets, rights of way and access plans - Regulation 5(2)(k) Sheet 2 of 4	TR010029/APP/2.4	0
2.4 Streets, rights of way and access plans - Regulation 5(2)(k) Sheet 3 of 4	TR010029/APP/2.4	<del>0</del> <u>1</u>
2.4 Streets, rights of way and access plans - Regulation 5(2)(k) Sheet 4 of 4	TR010029/APP/2.4	0

100  
Millimetres  
0 10  
DO NOT SCALE

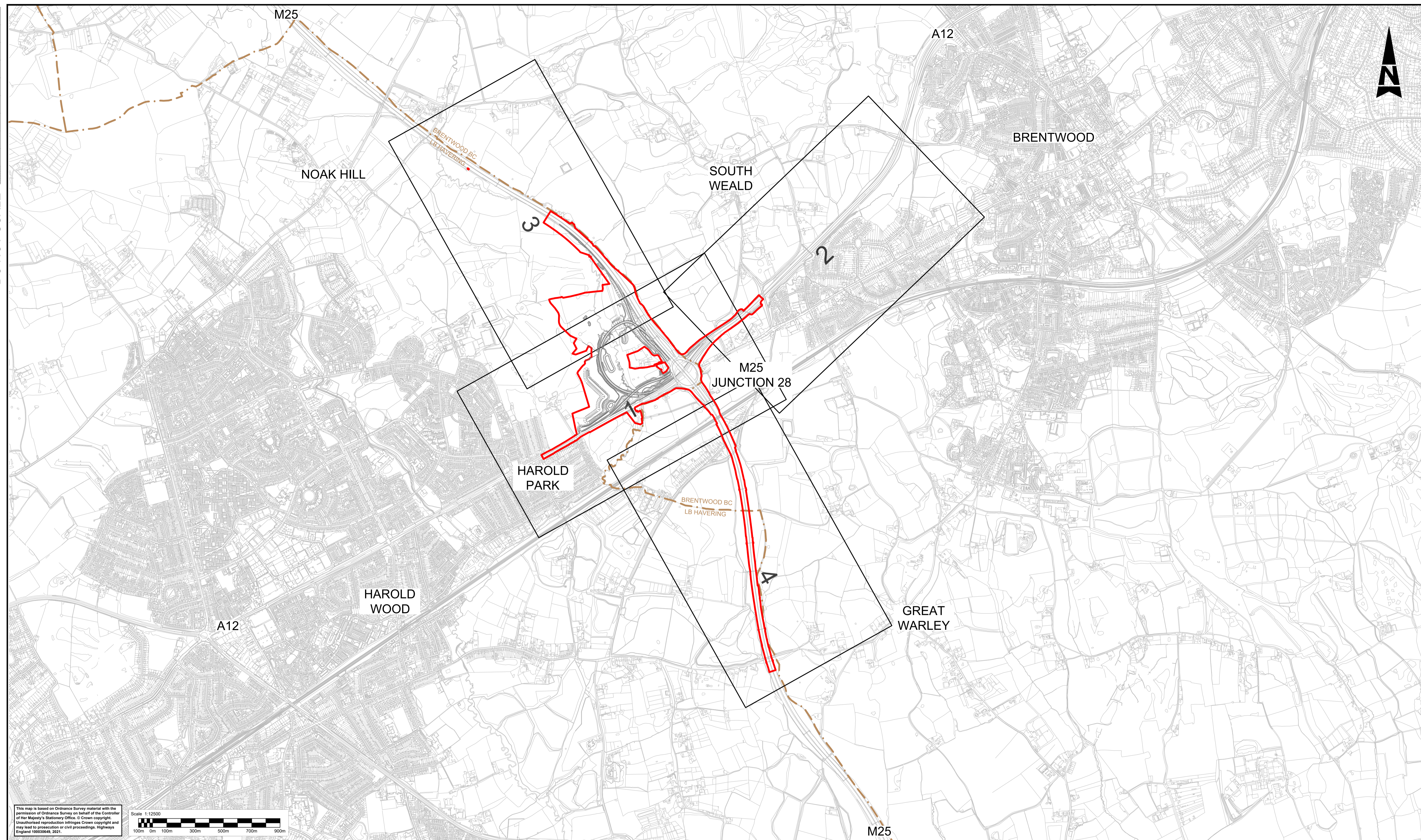

This map is based on Ordnance Survey material with the permission of Ordnance Survey on behalf of the Controller of Her Majesty's Stationery Office. © Crown copyright. Unauthorised reproduction infringes Crown copyright and may lead to prosecution or civil proceedings. Highways England 100030649, 2021.

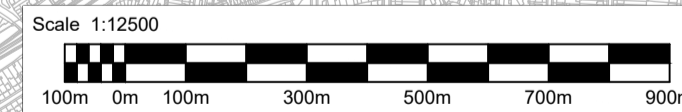

- LEGEND:**
- 2 PROPOSED WORKS TO STREETS, RIGHTS OF WAY, AND ACCESSES SHOWN IN THIS AREA.
  - DEVELOPMENT CONSENT ORDER (DCO) BOUNDARY
  - LOCAL AUTHORITY BOUNDARY

Description	Status	Revision	Drawn	Checked	Reviewed	Authorised	Issue Date

Drawing Suitability: **DCO EXAMINATION**

Status: **A4**

**SNC-LAVALIN**  
**ATKINS**

Member of the SNC-Lavalin Group  
Copyright © SNC Lavalin (2020)

Amlyn House  
Atkins 4th Floor  
90-96 Victoria Road  
Chelmsford  
Essex CM1 1QU  
Tel: +44 (0)1245 245245  
Fax: +44 (0)1245 345010  
www.atkinsglobal.com

Client: **Working on behalf of highways england**

Project Title: **M25 junction 28 improvement scheme**

Drawing Title: **STREETS, RIGHTS OF WAY AND ACCESS PLANS REGULATION 5(2)(k) KEY PLAN**

Drawing Number: **TR010029/APP/2.4**

Rev: **1**

HE PIN: HE551519 | Scale: 1:12500 | Original Size: A1

DO NOT SCALE

100  
0 10  
Millimetres

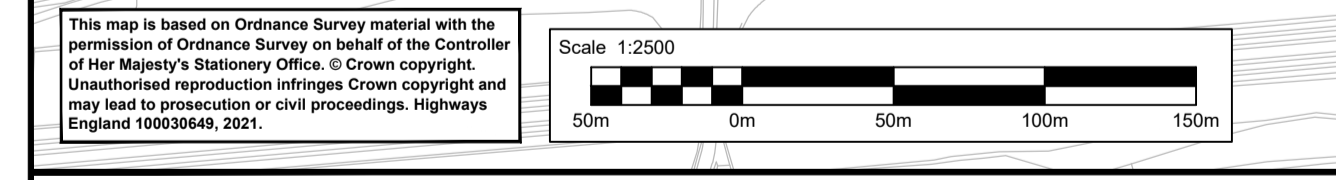
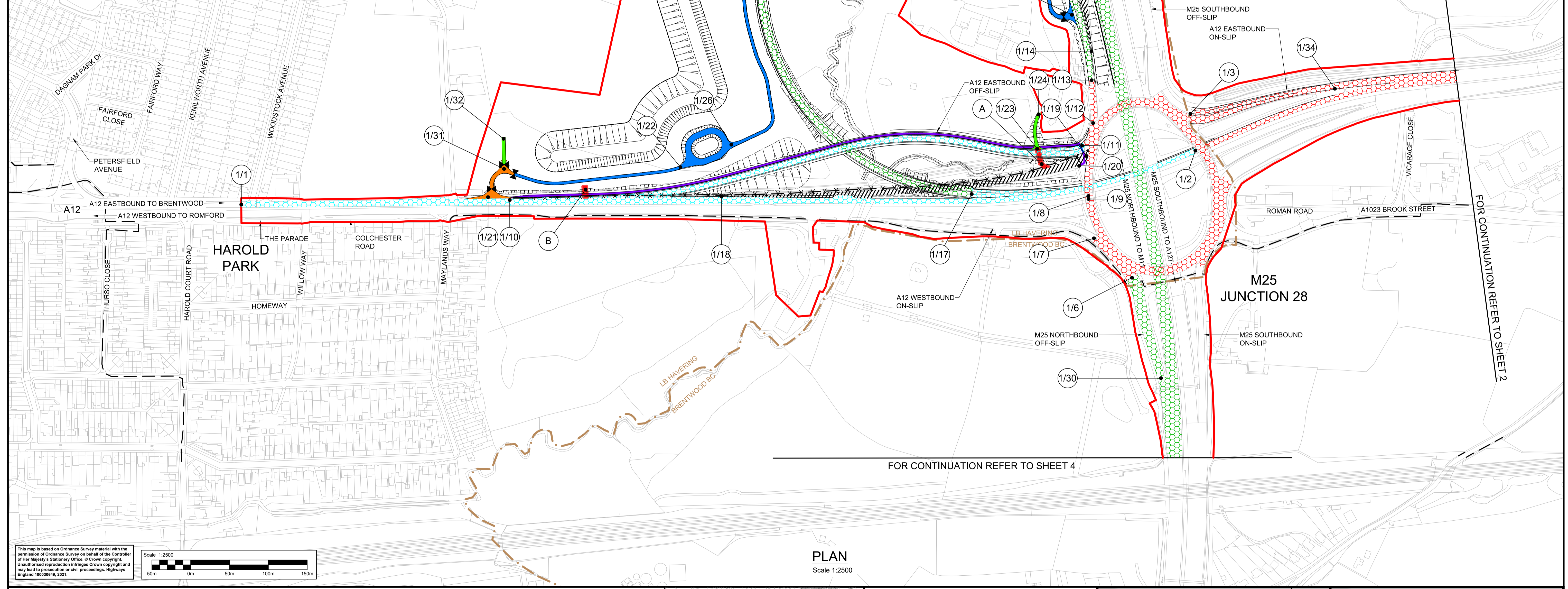
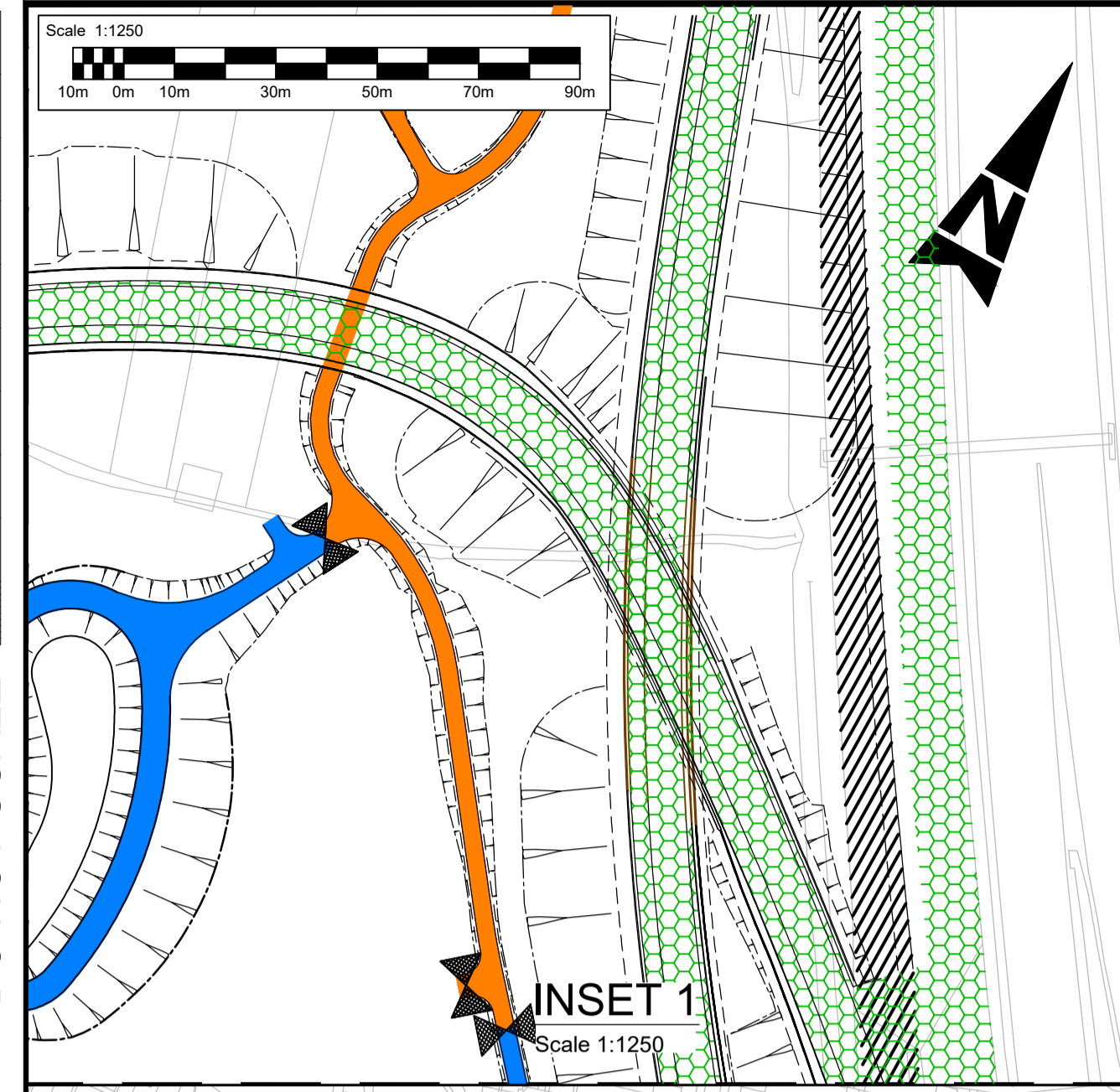

**Notes**

- These plans should be read in conjunction with the DCO (application document TR010029/APP/3.1), in particular Schedule 1: Authorised Development, Schedule 3: Permanent stopping up of streets and Schedule 4: Classification of Roads.
- All dimensions are in metres unless stated otherwise
- Do not scale from this drawing, use only printed dimensions

**Legend:**

	Development Consent Order (DCO) boundary		Private means of access to be stopped up
	Local Authority boundary		New/alterd private means of access - For existing land owners, Highways England and statutory undertakers
	Scheme layout (shown for illustrative purposes)		New/alterd private means of access - For Highways England
	Existing footway		New/alterd private means of access - For existing land owners
	Existing footway to be stopped up		Start/end point of highway / right of way to be improved, diverted, created, stopped up or extinguished
	Existing footway to be stopped up		New uncontrolled non-motorised user crossing
	New or diverted footpath or footway		Existing private means of access to be stopped up
	New, altered or improved highway - special road		Secure gate or barriers
	New, altered or improved highway - trunk road		
	New, altered or improved highway - Transport for London (TfL) road network		
	Existing highways to be stopped up		

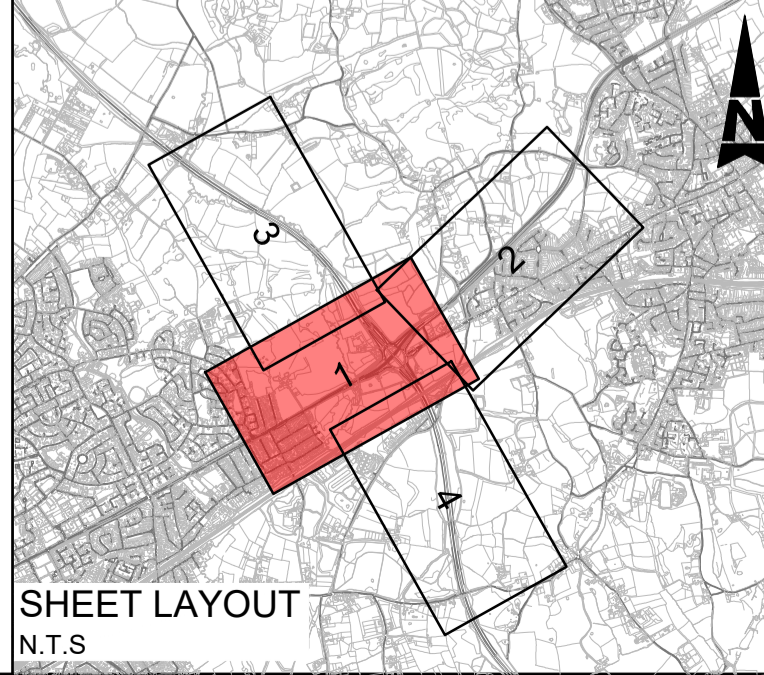

**PLAN**  
Scale 1:2500

Description	Status	Revision	Drawn	Checked	Reviewed	Authorised	Issue Date

Drawing Suitability	DCO EXAMINATION	Status	A4	Project Title	M25 junction 28 improvement scheme
		Amlin House Atkins 4th Floor 90-96 Victoria Road Chelmsford Essex CM1 1QU Tel: +44 (0)1245 245245 Fax: +44 (0)1245 345010 www.atkinsglobal.com		Drawing Title STREETS, RIGHTS OF WAY AND ACCESS PLANS REGULATION 5(2)(k) SHEET 1 OF 4	
Client	Working on behalf of	highways england	Drawing Number	TR010029/APP/2.4	Rev: 1
HE PIN: HE551519		Scale: AS SHOWN	Original Size: A1		

DO NOT SCALE

0 10 100  
Millimetres

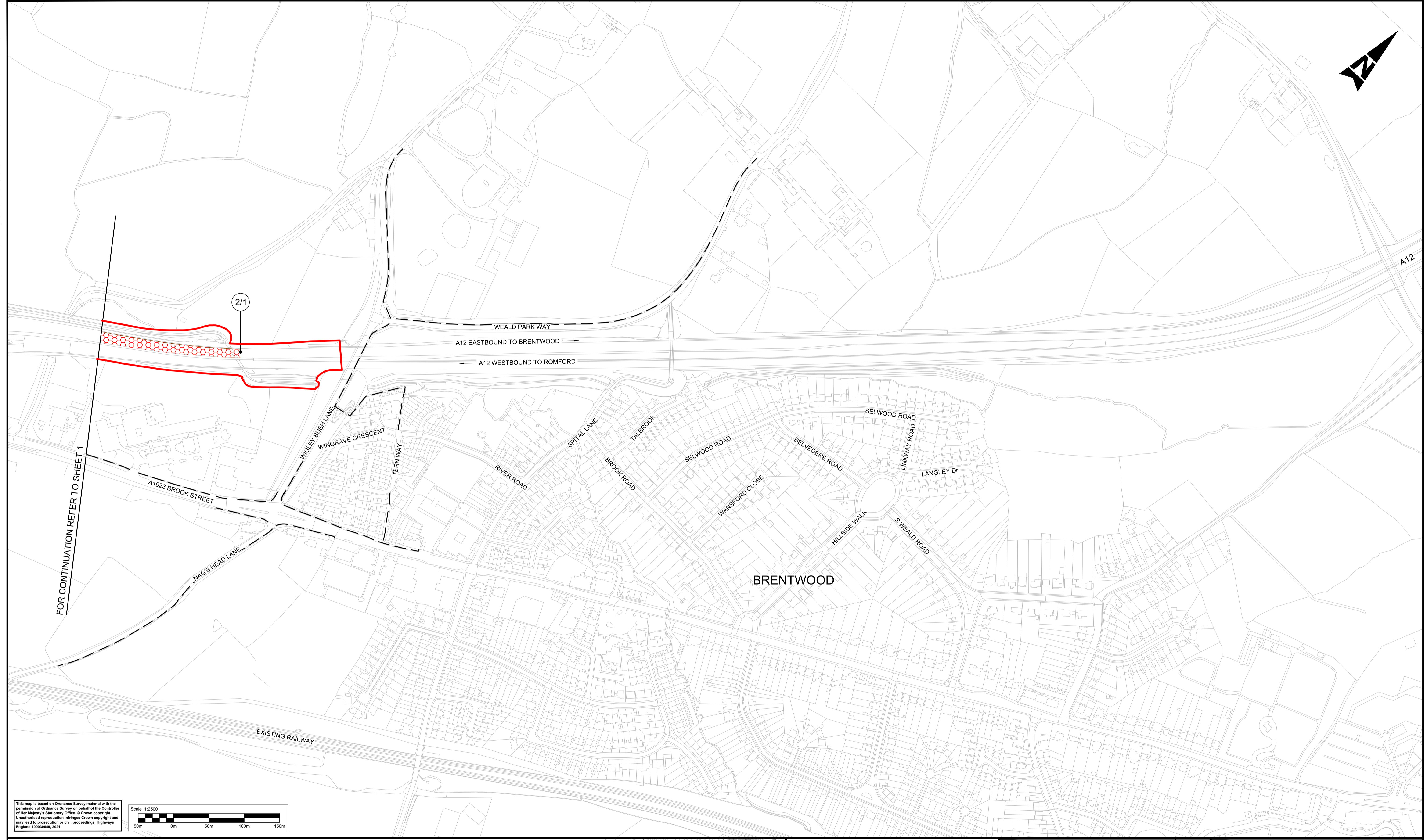
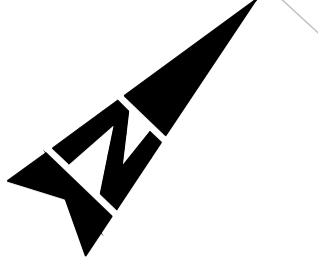

This map is based on Ordnance Survey material with the permission of Ordnance Survey on behalf of the Controller of Her Majesty's Stationery Office. © Crown copyright. Unauthorised reproduction infringes Crown copyright and may lead to prosecution or civil proceedings. Highways England 100030649, 2021.

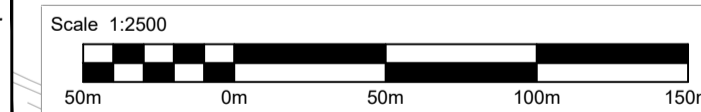

- Notes**
- These plans should be read in conjunction with the DCO (application document TR010029/APP/3.1), in particular Schedule 1: Authorised Development, Schedule 3: Permanent stopping up of streets and Schedule 4: Classification of Roads.
  - All dimensions are in metres unless stated otherwise
  - Do not scale from this drawing, use only printed dimensions

**Legend:**

- Development Consent Order (DCO) boundary
- Local Authority boundary
- Scheme layout (shown for illustrative purposes)
- Existing footway
- Existing footway to be stopped up
- New or diverted footpath or footway
- New, altered or improved highway - special road
- New, altered or improved highway - trunk road
- New, altered or improved highway - Transport for London (TfL) road network
- Existing highways to be stopped up
- Private means of access to be stopped up
- New/altered private means of access - For existing land owners, Highways England and statutory undertakers
- New/altered private means of access - For Highways England
- New/altered private means of access - For existing land owners.
- Start/end point of highway / right of way to be improved, diverted, created, stopped up or extinguished
- New uncontrolled non-motorised user crossing
- Existing private means of access to be stopped up
- Secure gate or barriers

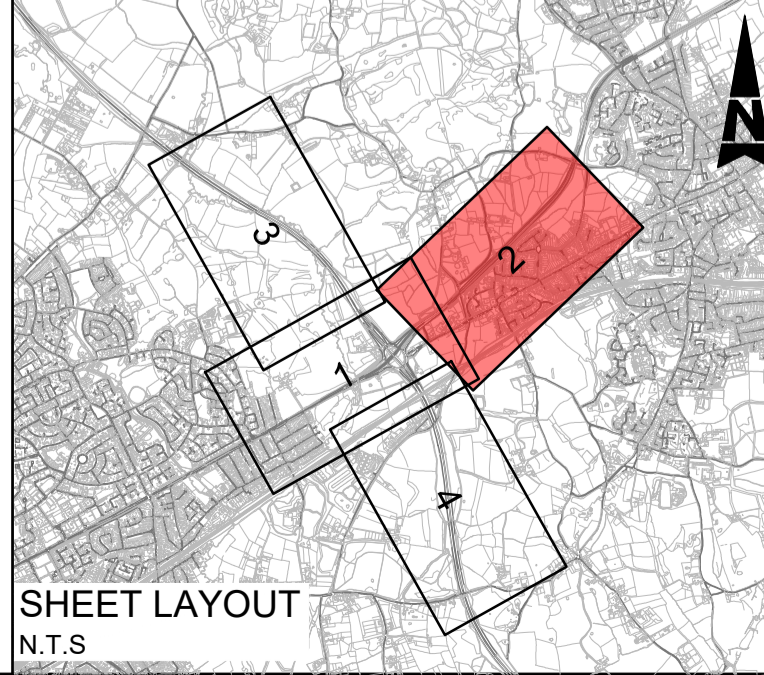

Description	Status	Revision	Drawn	Checked	Reviewed	Authorised	Issue Date

Drawing Suitability	Status	Project Title
DCO APPLICATION	A4	M25 junction 28 improvement scheme
		Drawing Title
Amlin House Atkins 4th Floor 90-96 Victoria Road Chelmsford Essex CM1 1QU Tel: +44 (0)1245 245245 Fax: +44 (0)1245 345010 Copyright © SNC Lavalin (2020) www.atkinglobal.com		STREETS, RIGHTS OF WAY AND ACCESS PLANS REGULATION 5(2)(k) SHEET 2 OF 4
Client	Working on behalf of	Drawing Number
		TR010029/APP/2.4
HE PIN: HE551519	Scale: 1:2500	Original Size: A1
		Rev: 0



DO NOT SCALE

Millimetres

0 10

100

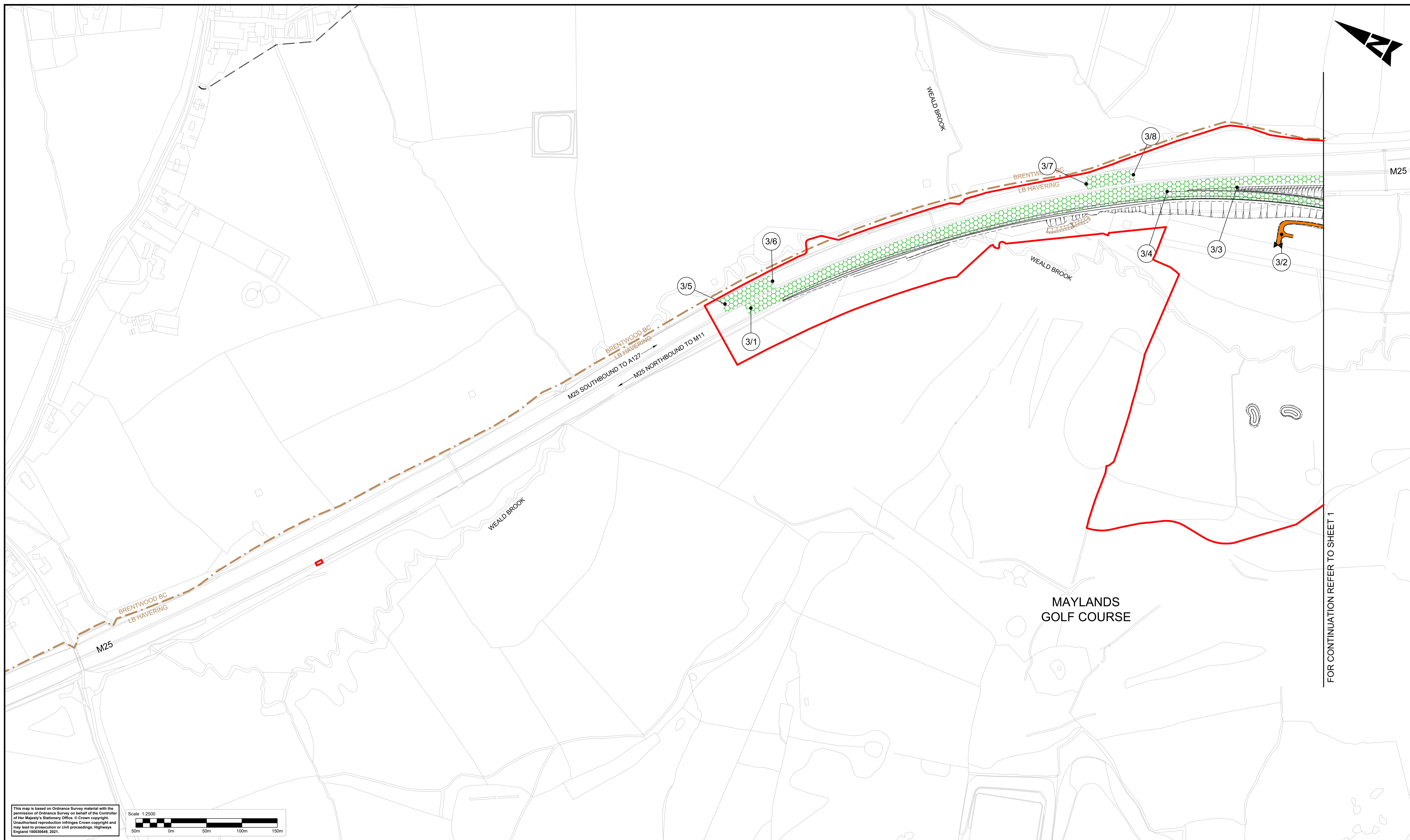

FOR CONTINUATION REFER TO SHEET 1

This map is based on Ordnance Survey material with the permission of Ordnance Survey on behalf of the Controller of Her Majesty's Stationery Office. © Crown copyright. Unauthorised reproduction infringes Crown copyright and may lead to prosecution or civil proceedings. Highways England 100030649, 2021.

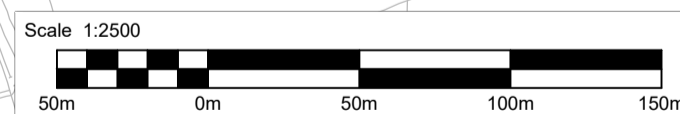

**Notes**

- These plans should be read in conjunction with the DCO (application document TR010029/APP/3.1), in particular Schedule 1: Authorised Development, Schedule 3: Permanent stopping up of streets and Schedule 4: Classification of Roads.
- All dimensions are in metres unless stated otherwise
- Do not scale from this drawing, use only printed dimensions

**Legend:**

- Development Consent Order (DCO) boundary
- Local Authority boundary
- Scheme layout (shown for illustrative purposes)
- Existing footway
- Existing footway to be stopped up
- New or diverted footpath or footway
- New, altered or improved highway - special road
- New, altered or improved highway - trunk road
- New, altered or improved highway - Transport for London (TfL) road network
- Existing highways to be stopped up
- Private means of access to be stopped up
- New/altered private means of access - For existing land owners, Highways England and statutory undertakers
- New/altered private means of access - For Highways England
- New/altered private means of access - For existing land owners.
- 1/2 Start/end point of highway / right of way to be improved, diverted, created, stopped up or extinguished
- 1/a New uncontrolled non-motorised user crossing
- A Existing private means of access to be stopped up
- Secure gate or barriers

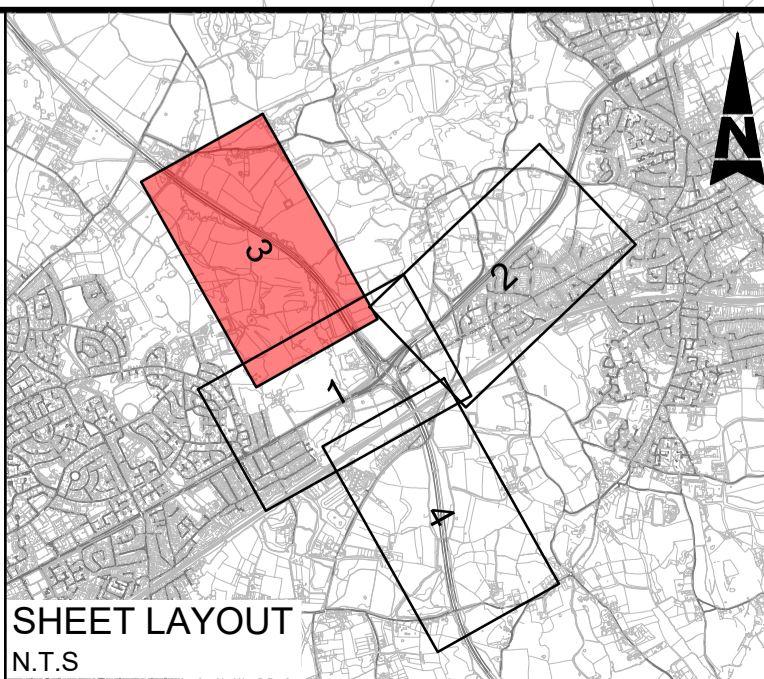

Description	Status	Revision	Drawn	Checked	Reviewed	Authorised	Issue Date

Drawing Suitability	Status	Project Title
DCO EXAMINATION	A4	M25 junction 28 improvement scheme
<p>Member of the SNC-Lavalin Group Copyright © SNC Lavalin (2020)</p>		Drawing Title
<p>Amlyn House Atkins 4th Floor 90-96 Victoria Road Chelmsford Essex CM1 1QU Tel: +44 (0)1245 245245 Fax: +44 (0)1245 345010 www.atkinsglobal.com</p>		STREETS, RIGHTS OF WAY AND ACCESS PLANS REGULATION 5(2)(k) SHEET 3 OF 4
Client	Working on behalf of	Drawing Number
		TR010029/APP/2.4
		1
HE PIN: HE551519	Scale: 1:2500	Original Size: A1

DO NOT SCALE  
0 10 100  
Millimetres

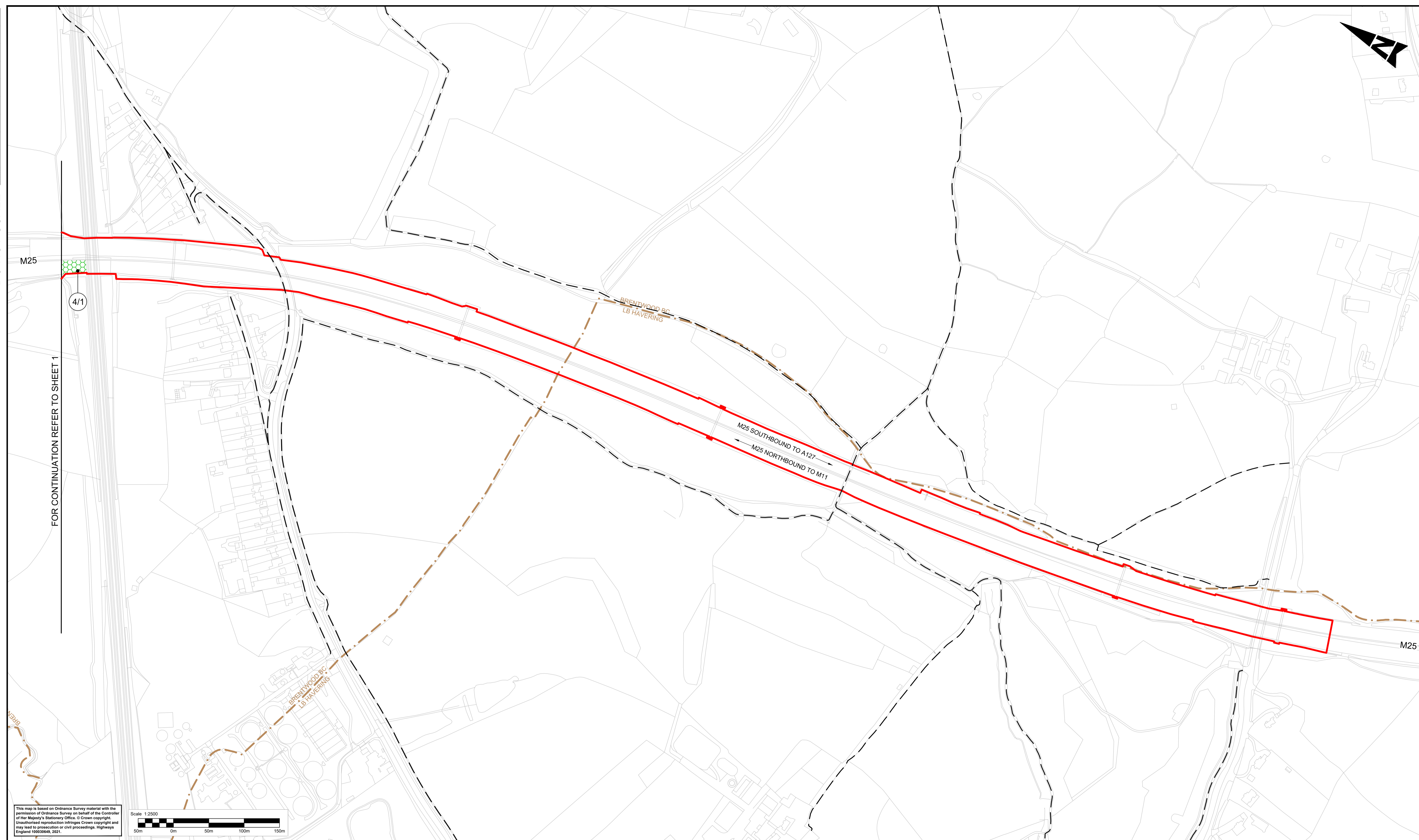

FOR CONTINUATION REFER TO SHEET 1

This map is based on Ordnance Survey material with the permission of Ordnance Survey on behalf of the Controller of Her Majesty's Stationery Office. © Crown copyright. Unauthorised reproduction infringes Crown copyright and may lead to prosecution or civil proceedings. Highways England 100030649, 2021.

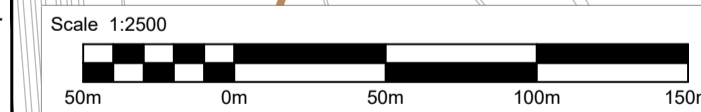

- Notes**
- These plans should be read in conjunction with the DCO (application document TR010029/APP/3.1), in particular Schedule 1: Authorised Development, Schedule 3: Permanent stopping up of streets and Schedule 4: Classification of Roads.
  - All dimensions are in metres unless stated otherwise
  - Do not scale from this drawing, use only printed dimensions

**Legend:**

	Development Consent Order (DCO) boundary		Private means of access to be stopped up
	Local Authority boundary		New/alterd private means of access - For existing land owners, Highways England and statutory undertakers
	Scheme layout (shown for illustrative purposes)		New/alterd private means of access - For Highways England
	Existing footway		New/alterd private means of access - For existing land owners.
	Existing footway to be stopped up		Start/end point of highway / right of way to be improved, diverted, created, stopped up or extinguished
	New or diverted footpath or footway		New uncontrolled non-motorised user crossing
	New, altered or improved highway - special road		Existing private means of access to be stopped up
	New, altered or improved highway - trunk road		Secure gate or barriers
	New, altered or improved highway - Transport for London (TfL) road network		
	Existing highways to be stopped up		

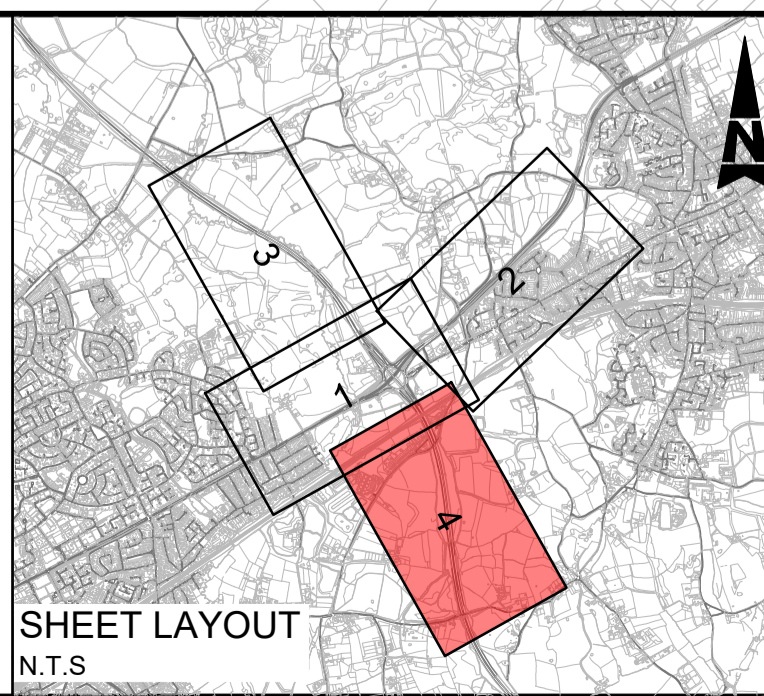

Description	Status	Revision	Drawn	Checked	Reviewed	Authorised	Issue Date

Drawing Suitability		Status	Project Title
DCO APPLICATION		A4	M25 junction 28 improvement scheme
		Drawing Title	
Amlin House Atkins 4th Floor 90-96 Victoria Road Chelmsford Essex CM1 1QU Tel: +44 (0)1245 245245 Fax: +44 (0)1245 345010 www.atkinsglobal.com		<b>STREETS, RIGHTS OF WAY          AND ACCESS PLANS          REGULATION 5(2)(k)          SHEET 4 OF 4</b>	
Client		Drawing Number	Rev:
		TR010029/APP/2.4	0
HE PIN: HE551519		Scale: 1:2500	Original Size: A1

© Crown copyright (2021)

You may re-use this information (not including logos) free of charge in any format or medium, under the terms of the Open Government Licence. To view this licence:

visit [www.nationalarchives.gov.uk/doc/open-government-licence/](http://www.nationalarchives.gov.uk/doc/open-government-licence/)  
write to the Information Policy Team, **The National Archives, Kew, London TW9 4DU**,  
or email [psi@nationalarchives.gsi.gov.uk](mailto:psi@nationalarchives.gsi.gov.uk).

Printed on paper from well-managed forests and other controlled sources.

Registered office Bridge House, 1 Walnut Tree Close, Guilford GU1 4LZ  
Highways England Company Limited registered in England and Wales number 09346363